

## #26 MINI 4 FLAT F

---

1	SK	Montážny návod
2	CZ	Montážní návod
3	DE	Montageanleitung
4	ENG	Assembly instructions
5	PL	Instrukcja montażu
6	RO	Instrucțiuni de montaj
7	IT	Istruzioni di montaggio

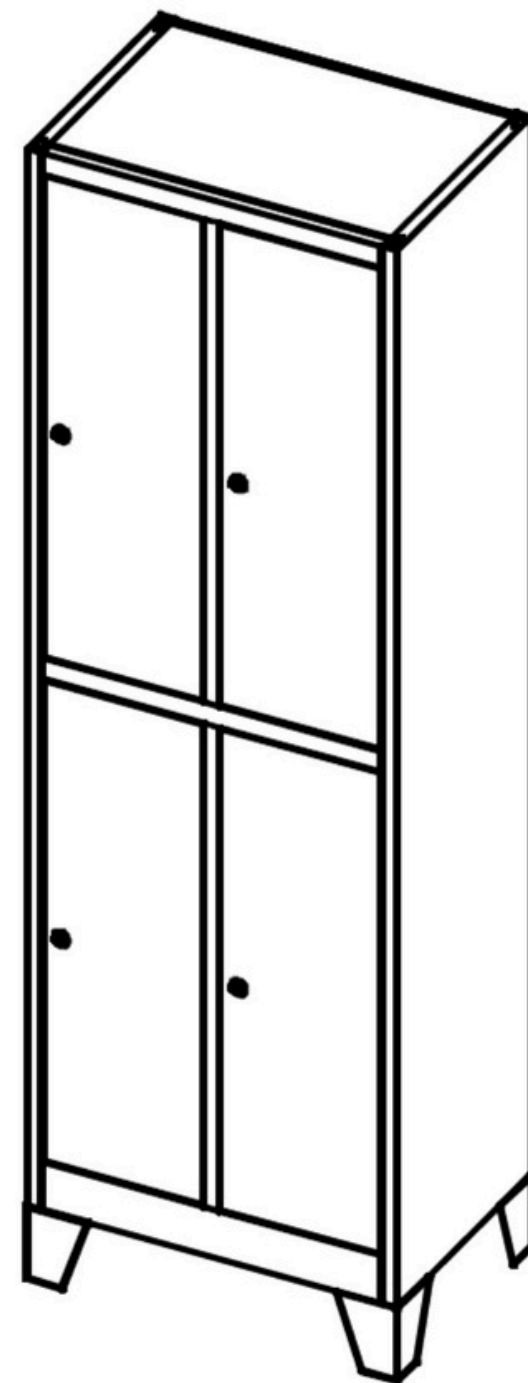

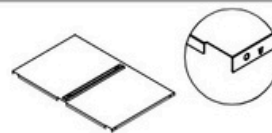
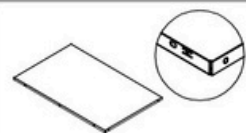

Horná doska: 1 ks

Stredná doska: 1 ks

Samorezné skrutky (5x10): 30 ks

Háčiky: 8 kusov

Horná deliaca priečka: 1 ks

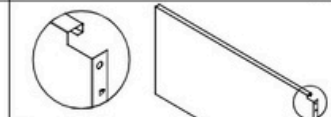
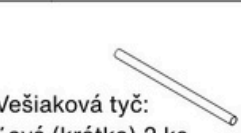
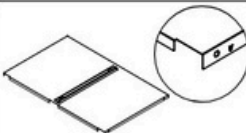

Spodná doska: 1 ks

Vešiaková tyč:  
Ľavá (krátka) 2 ks  
Pravá (dlhá) 2 ks

Kľúče: 4 sety

Nožičky: 4 ks

Spodná deliaca priečka: 1 ks

Ľavá strana: 1 ks

Pravá strana: 1 ks

Rám dverí: 1 ks

Zadná doska: 1 ks

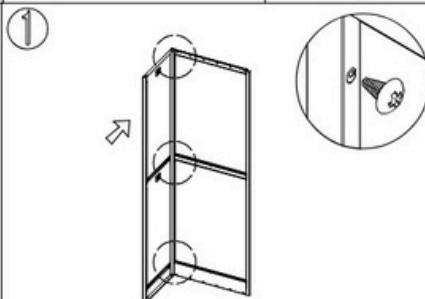
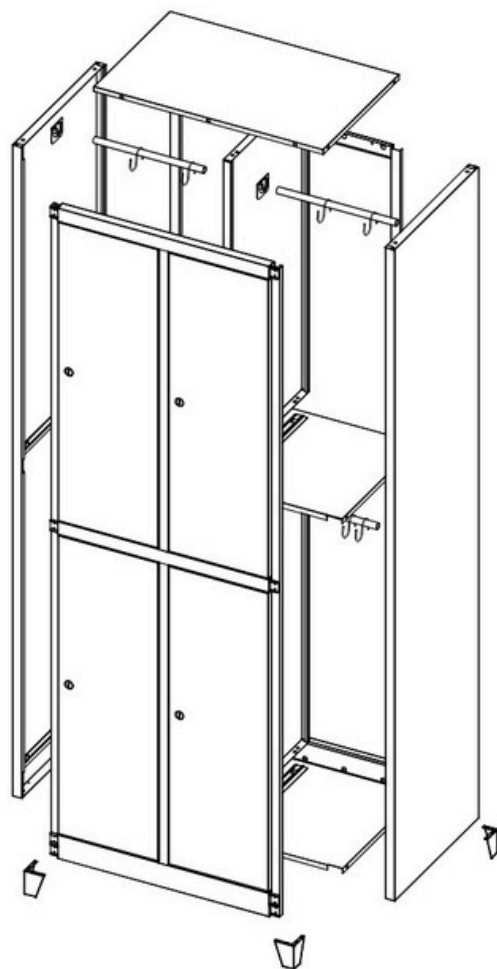

1 Priskrutkujte ľavú stranu a zadnú dosku samoreznými skrutkami (5x10)

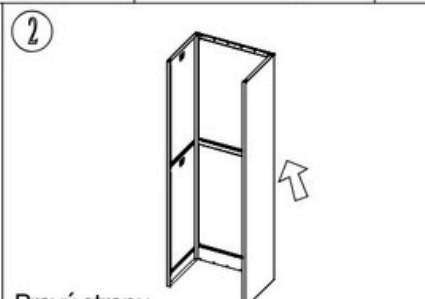

2 Pravú stranu priskrutkujte k zadnej doske rovnakým spôsobom ako v prvom kroku

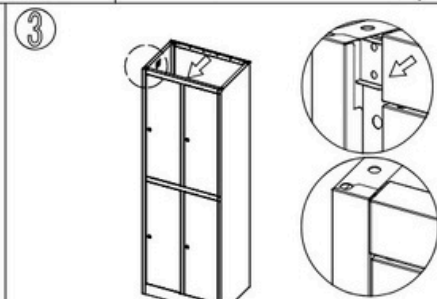

3 Pripevnite zárubňu dverí na obe bočné dosky

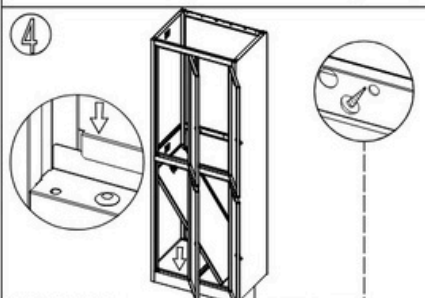

4 Nainštalujte spodnú dosku a potom rovnakým spôsobom nainštalujte spodnú deliacu dosku

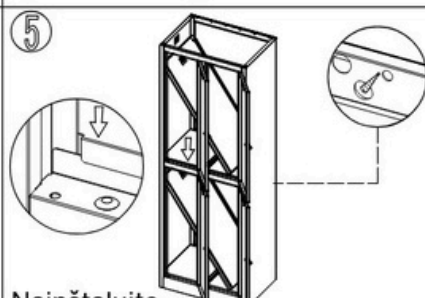

5 Nainštalujte strednú dosku a potom nainštalujte hornú deliacu dosku podľa výkresu.

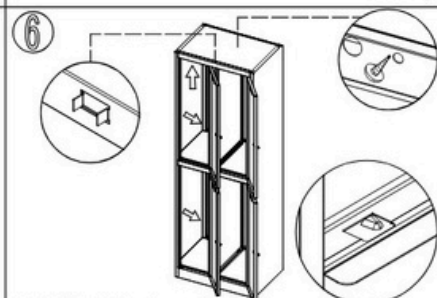

6 Nainštalujte hornú dosku a potom nastavte hornú a dolnú deliacu dosku, kým dobre nezapadnú

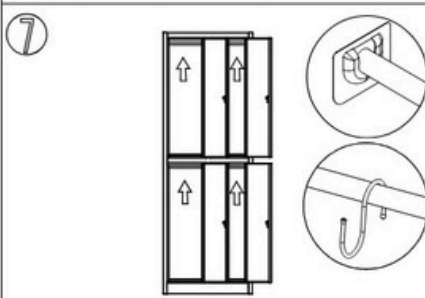

7 Nainštalujte závesnú tyč a háčik

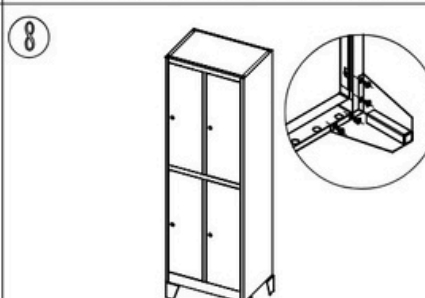

8 Nainštalujte nožičky pomocou skrutiek (5x10)

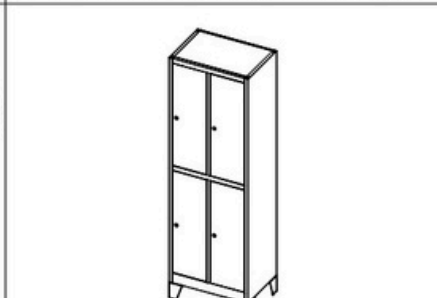

Po inštalácii upravte každú časť tak, aby dobre sedela.

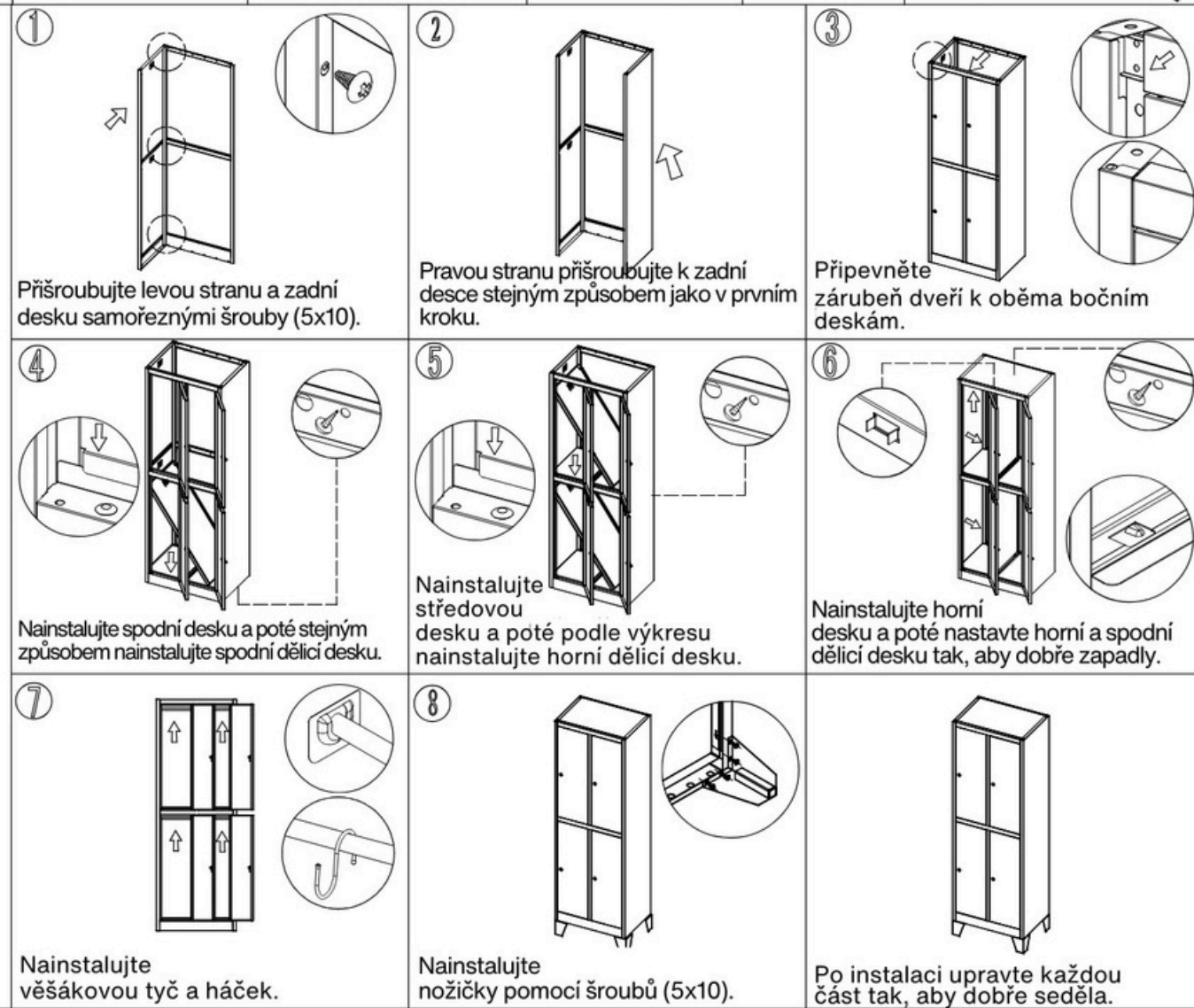
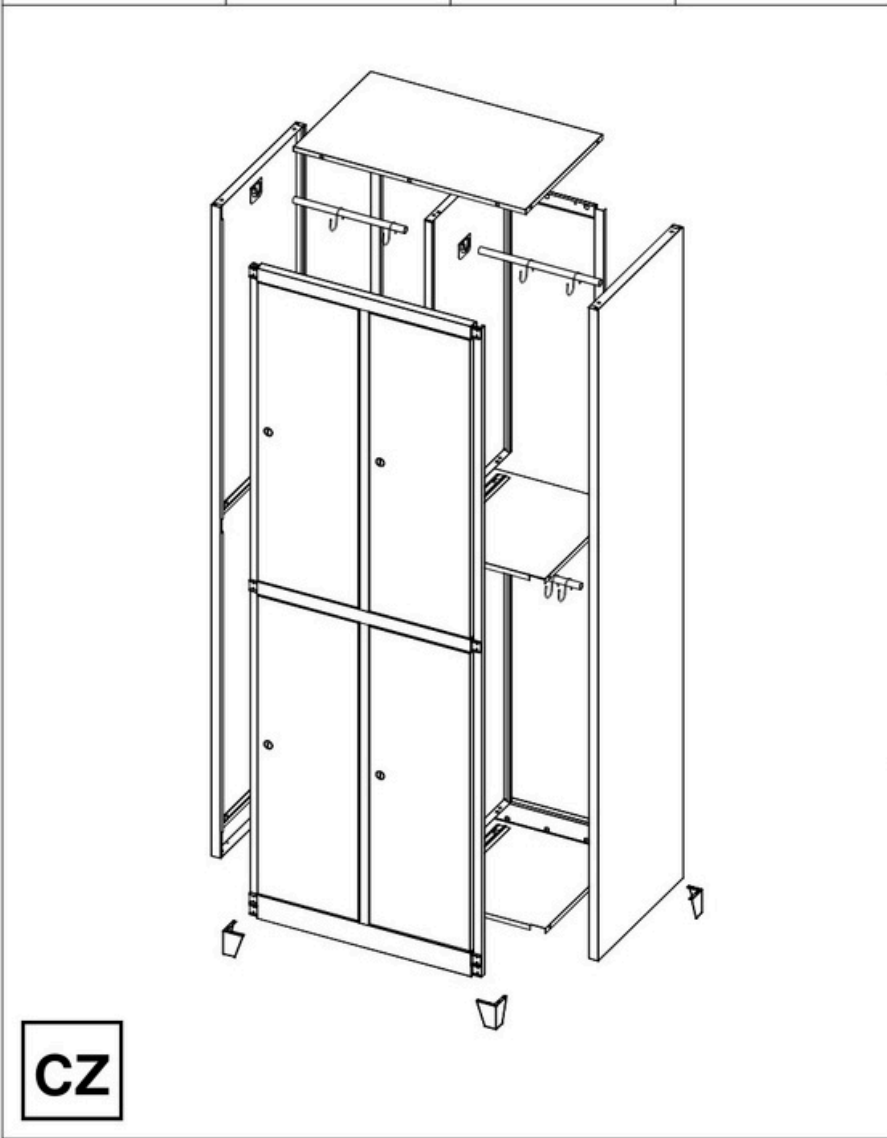
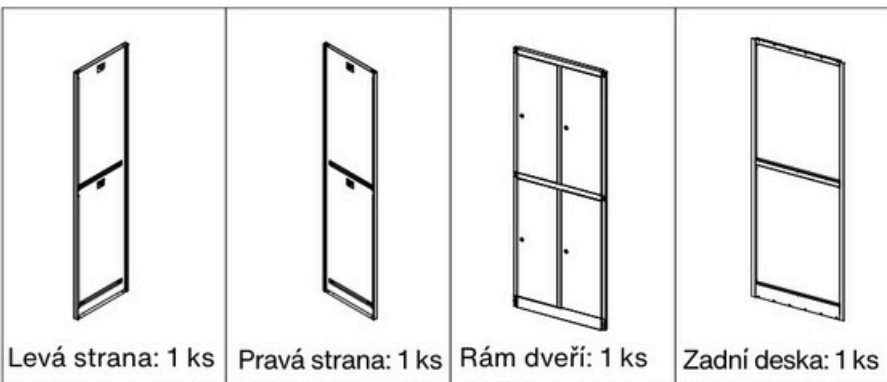

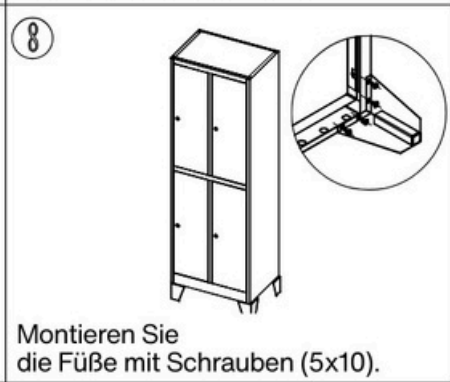
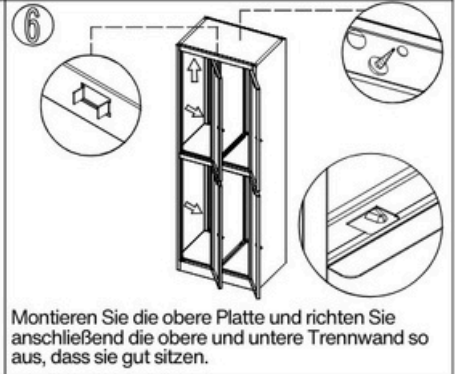
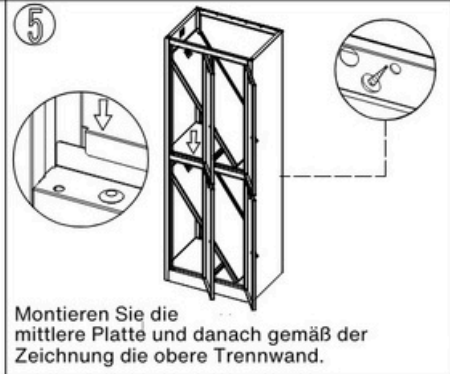
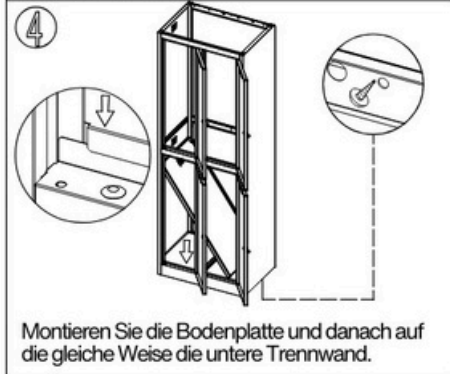
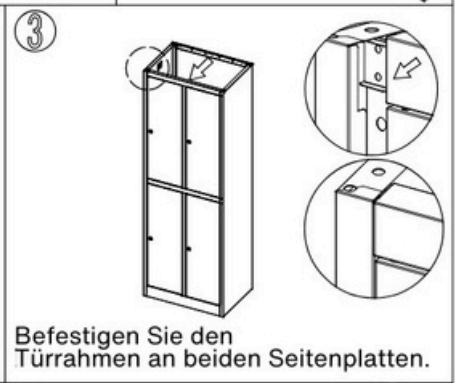
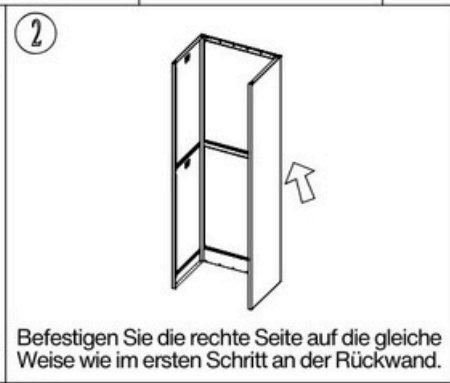
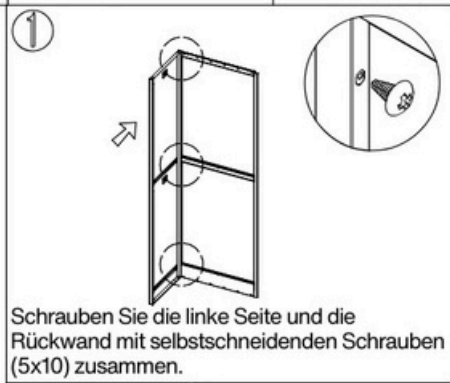
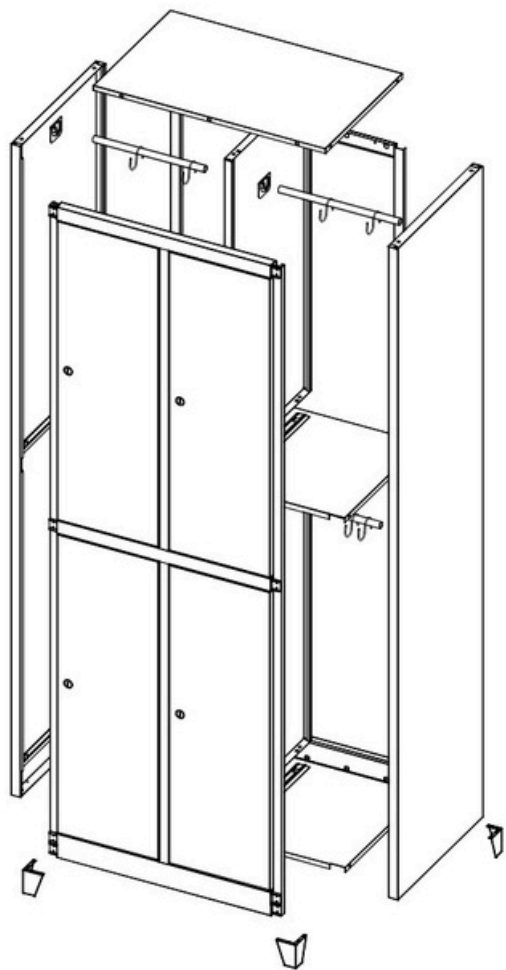
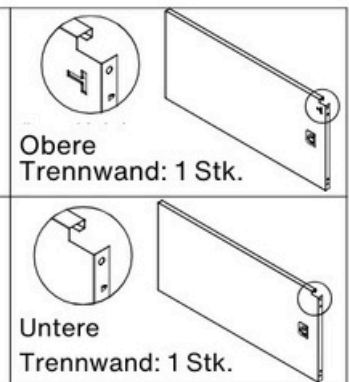
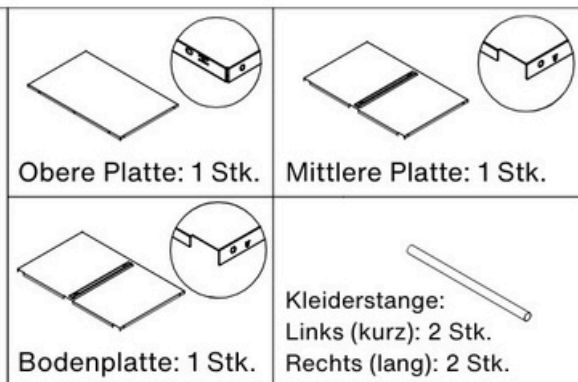
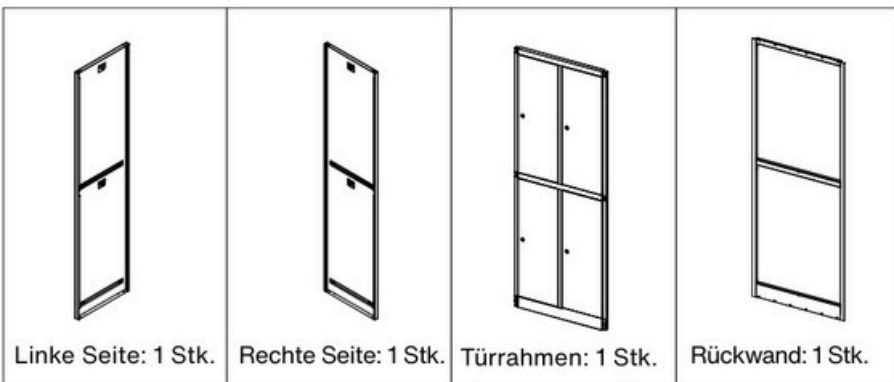

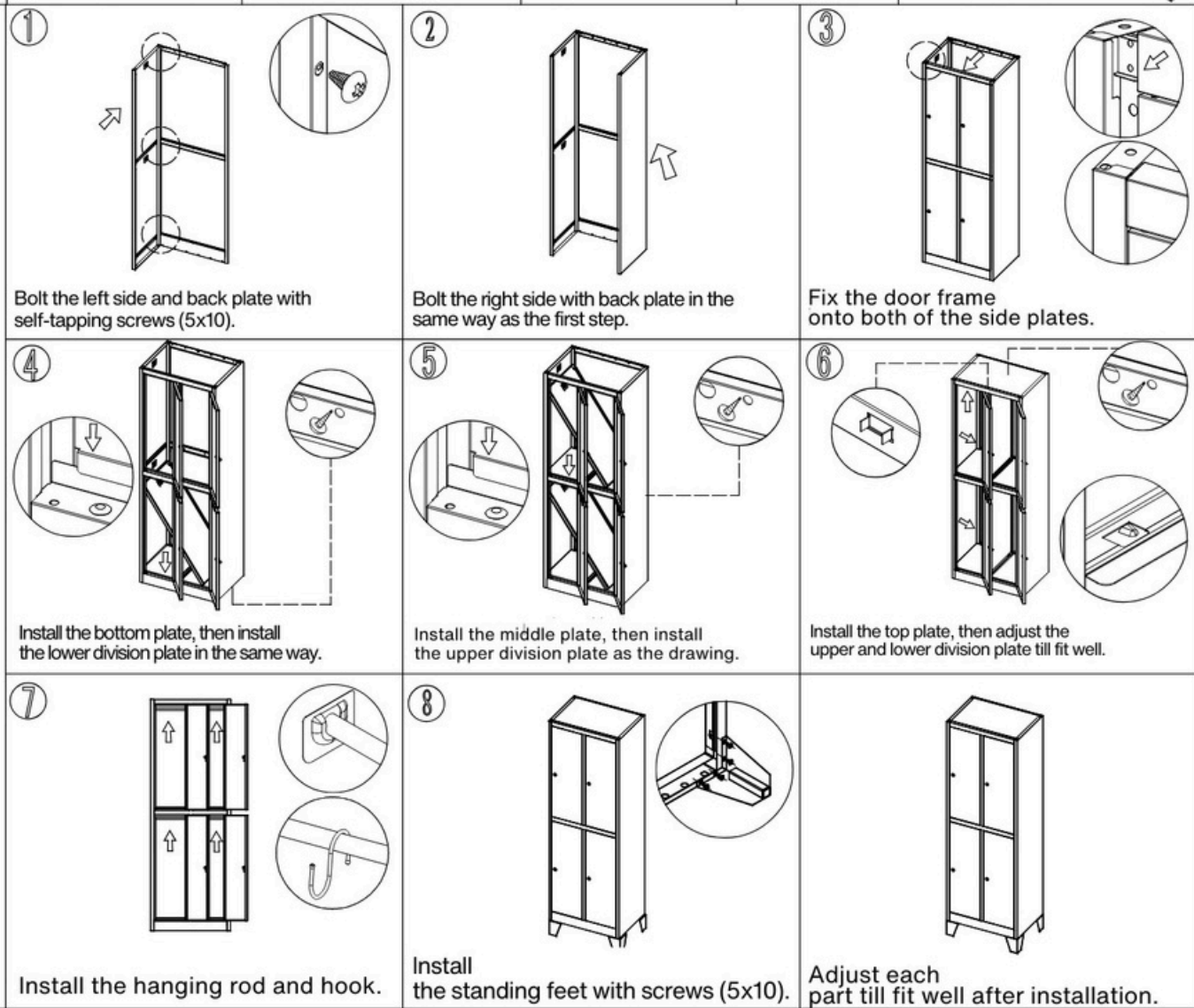
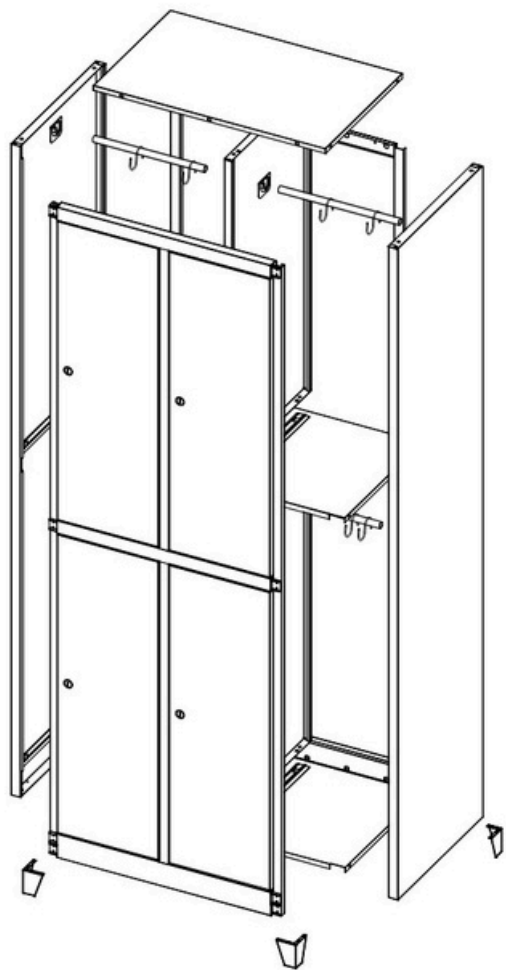
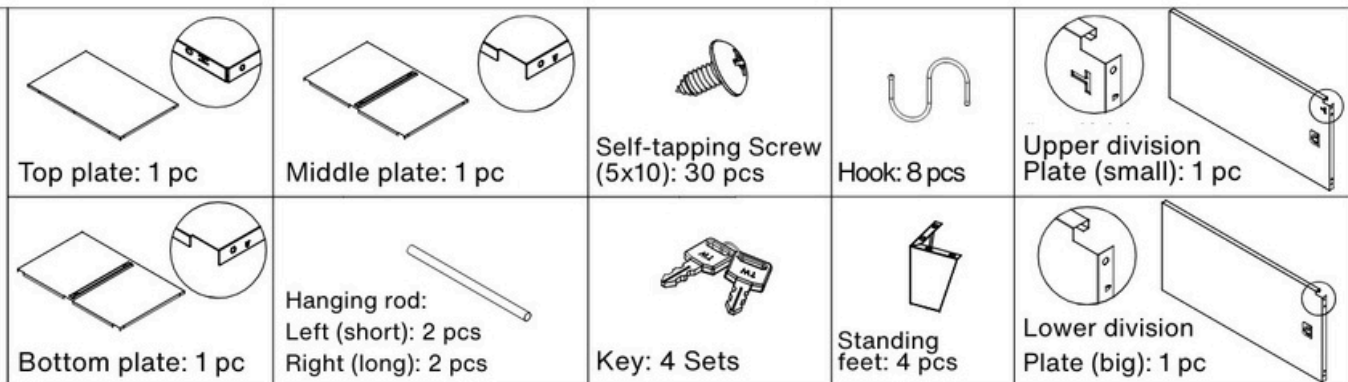
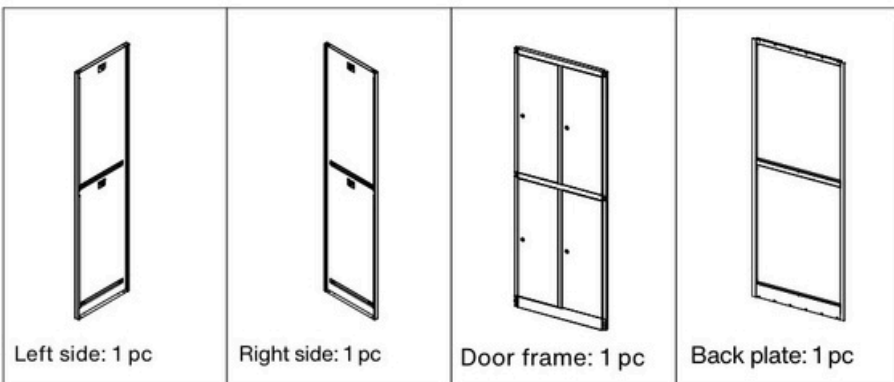

ENG

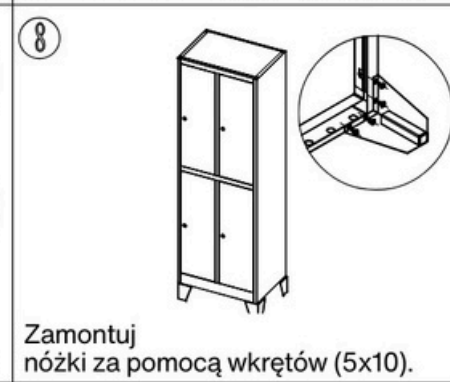
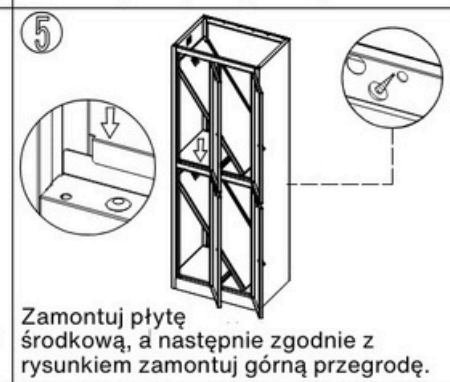
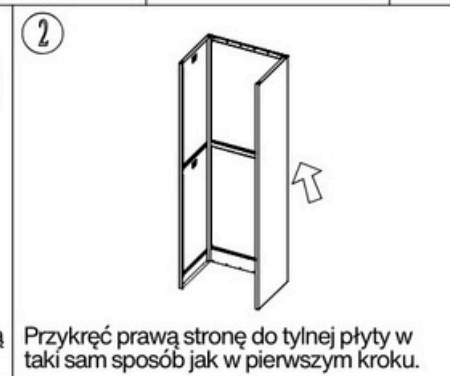
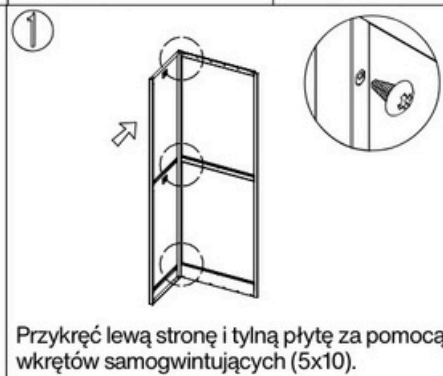
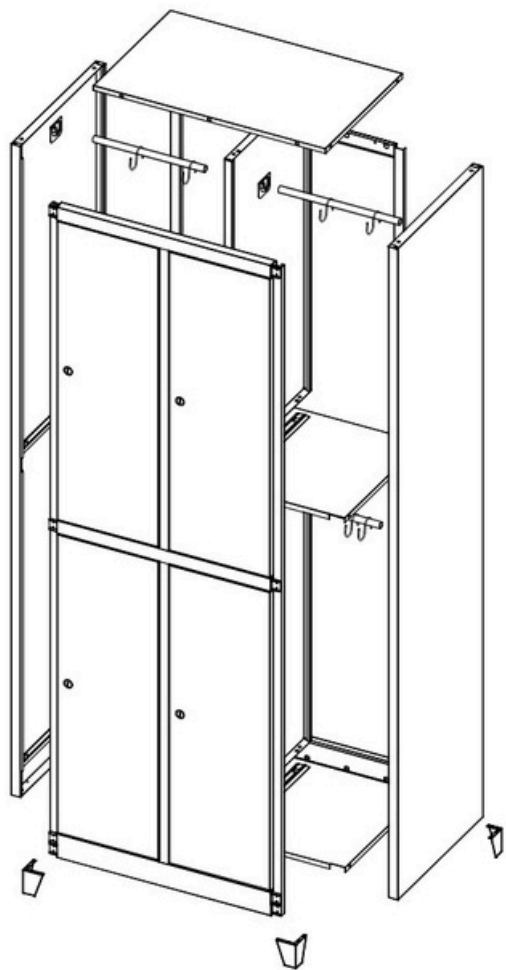
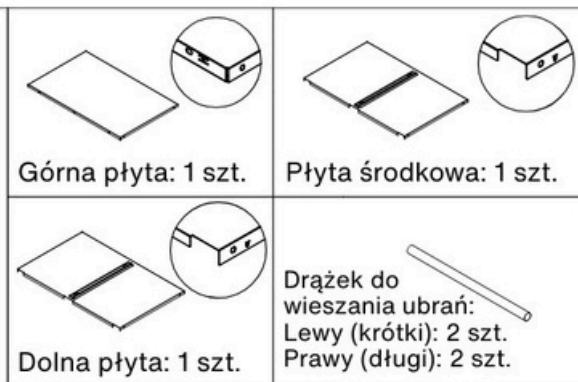
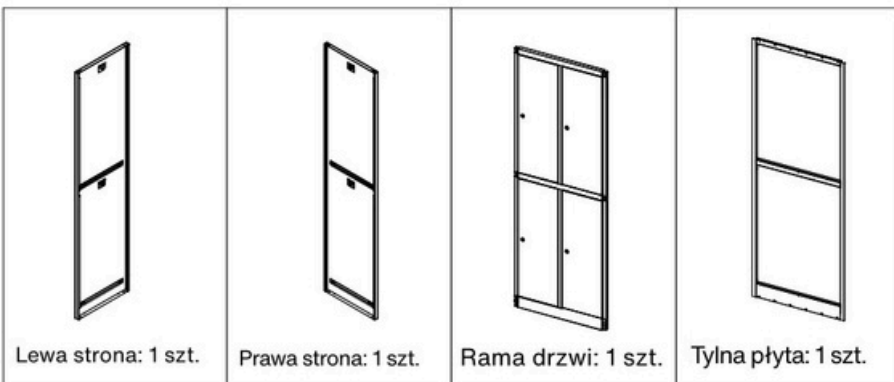

PL



Partea stângă:  
1 buc.



Partea dreaptă: 1 buc.

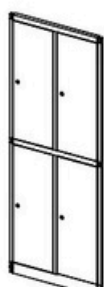

Rama uşii: 1 buc.



Panoul din spate: 1 buc.

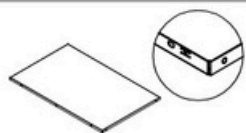

Panoul superior: 1 buc.

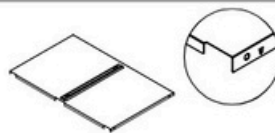

Panoul central: 1 buc.



Şuruburi  
ăufiletante  
(5x10): 30 buc.



Cârlige: 8 bucăţi



Panou  
despărţitor  
superior: 1 buc.

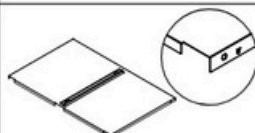

Panoul inferior: 1 buc.

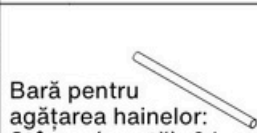

Bară pentru  
agăţarea hainelor:  
Stânga (scurtă): 2 buc.  
Dreapta (lungă): 2 buc.



Chei: 4 seturi



Picioare: 4 buc



Panou  
despărţitor  
inferior: 1 buc.

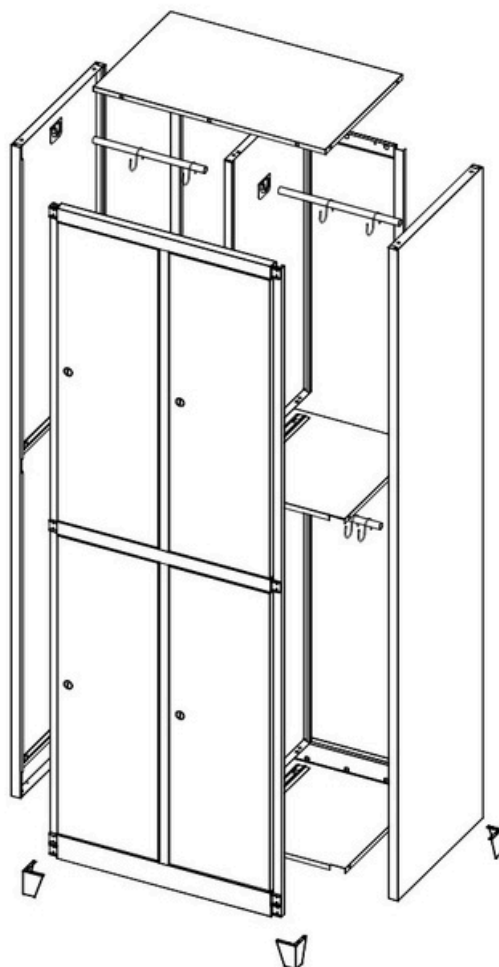

1 Înşurubaţi partea stângă şi panoul din spate folosind şuruburi autofiletante (5x10).



2 Fixaţi partea dreaptă de panoul din spate în acelaşi mod ca la primul pas.



3 Fixaţi tocul uşii pe ambele panouri laterale.

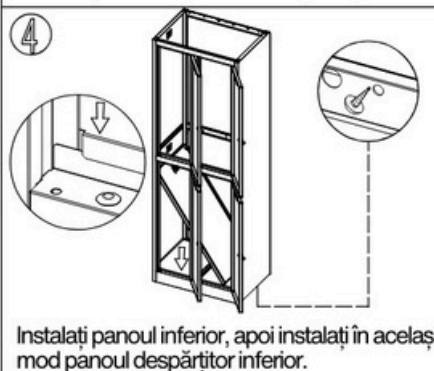

4 Instalaţi panoul inferior, apoi instalaţi în acelaşi mod panoul despărţitor inferior.

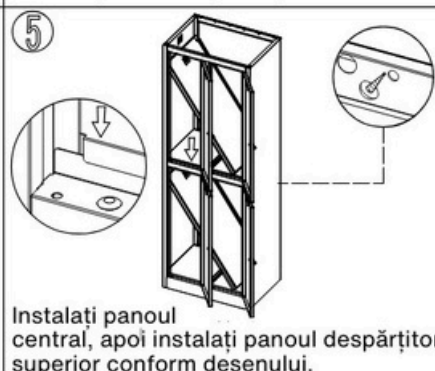

5 Instalaţi panoul central, apoi instalaţi panoul despărţitor superior conform desenului.



6 Instalaţi panoul superior, apoi reglaţi panourile despărţitoare superioare şi inferioare până când se potrivesc bine.

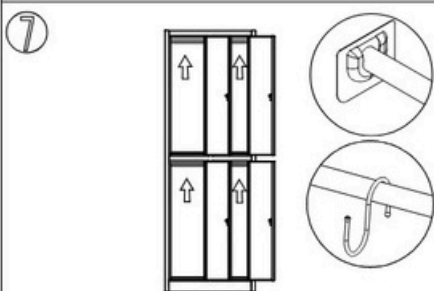

7 Instalaţi bara pentru haine şi cârligul.

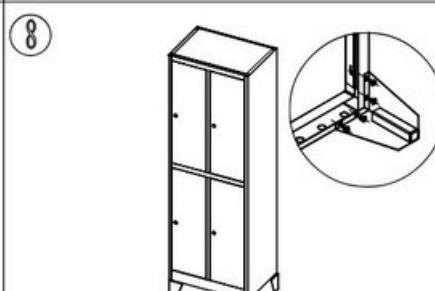

8 Instalaţi picioarele folosind şuruburi (5x10).

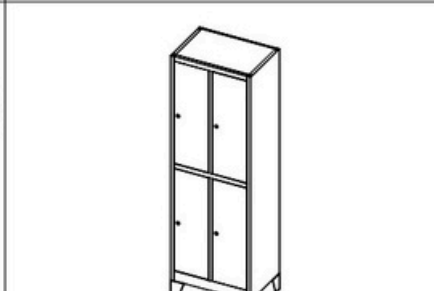

După instalare, ajustaţi fiecare parte astfel încât să se potrivească bine



Lato sinistro: 1 pz



Lato destro: 1 pz



Telaio della porta: 1 pz



Pannello posteriore: 1 pz

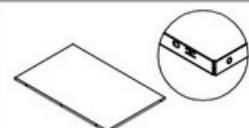

Pannello superiore: 1 pz



Pannello centrale: 1 pz



Viti autofilettanti (5x10): 30 pz



Ganci: 8 pezzi



Divisorio superiore: 1 pz

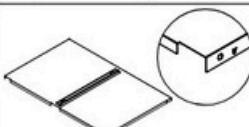
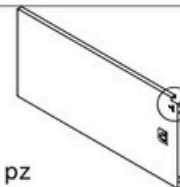

Pannello inferiore: 1 pz



Barra appendiabiti:  
Sinistra (corta): 2 pz  
Destra (lunga): 2 pz



Chiavi: 4 set



Piedini: 4 pz



Divisorio inferiore: 1 pz

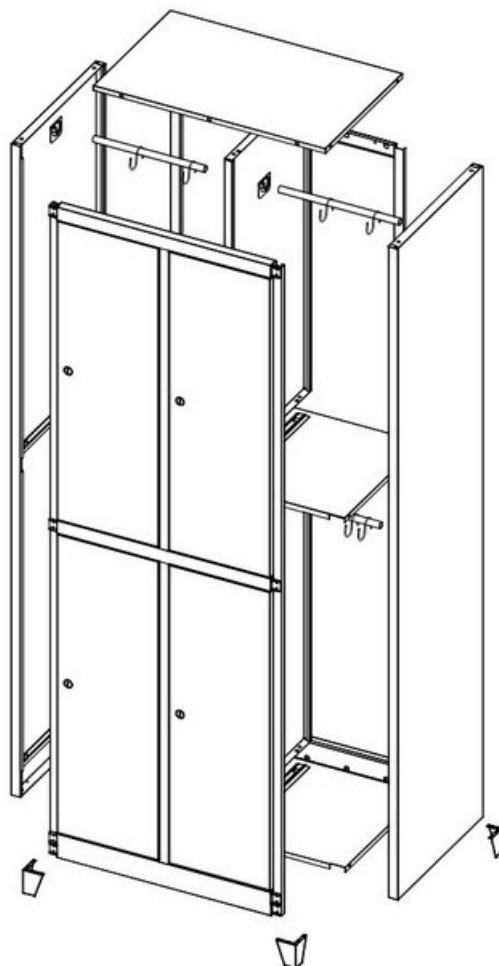
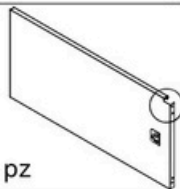

1 Avvitare il lato sinistro e il pannello posteriore utilizzando le viti autofilettanti (5x10).



2 Fissare il lato destro al pannello posteriore nello stesso modo del primo passaggio.



3 Fissare il telaio della porta a entrambi i pannelli laterali.



4 Installare il pannello inferiore e successivamente installare nello stesso modo il divisorio inferiore.



5 Installare il pannello centrale e poi installare il divisorio superiore secondo il disegno.



6 Installare il pannello superiore e quindi regolare i divisori superiore e inferiore finché non si adattano correttamente.



7 Installare la barra appendiabiti e il gancio.



8 Installare i piedini con le viti (5x10).



Dopo l'installazione, regolare ogni parte in modo che si adatti correttamente.